



76,862 RSF NEW CONSTRUCTION
CLASS A OFFICE SPACE

THE EDISON SUNCOAST

1785 NORTHPOINTE PARKWAY • LUTZ, FL 33558

54 CORRIDOR, PASCO COUNTY



CBRE

LOCATION HIGHLIGHTS

- Immediate Proximity to the Suncoast Parkway allows an 18 minute drive to Tampa International Airport
- Counter-Traffic makes for an easy commute to downtown Tampa. 25-35 minutes 9am-5pm
- Excellent access from S.R. 54
- Pasco County rent tax = 6.5% vs. 7.0% in Hillsborough
- Location is outside of Hurricane Evacuation Zones



MODERN
CREATIVE LOFT
DESIGN

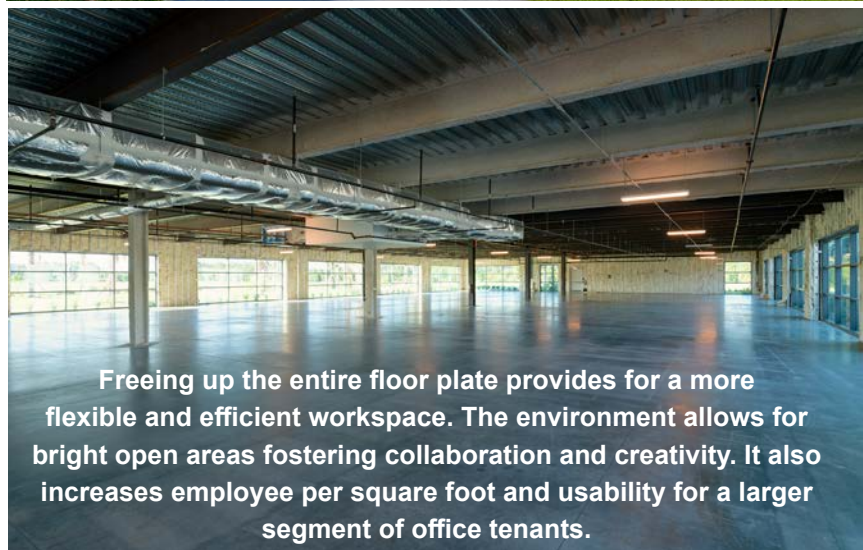

Freeing up the entire floor plate provides for a more flexible and efficient workspace. The environment allows for bright open areas fostering collaboration and creativity. It also increases employee per square foot and usability for a larger segment of office tenants.



SITE PLAN

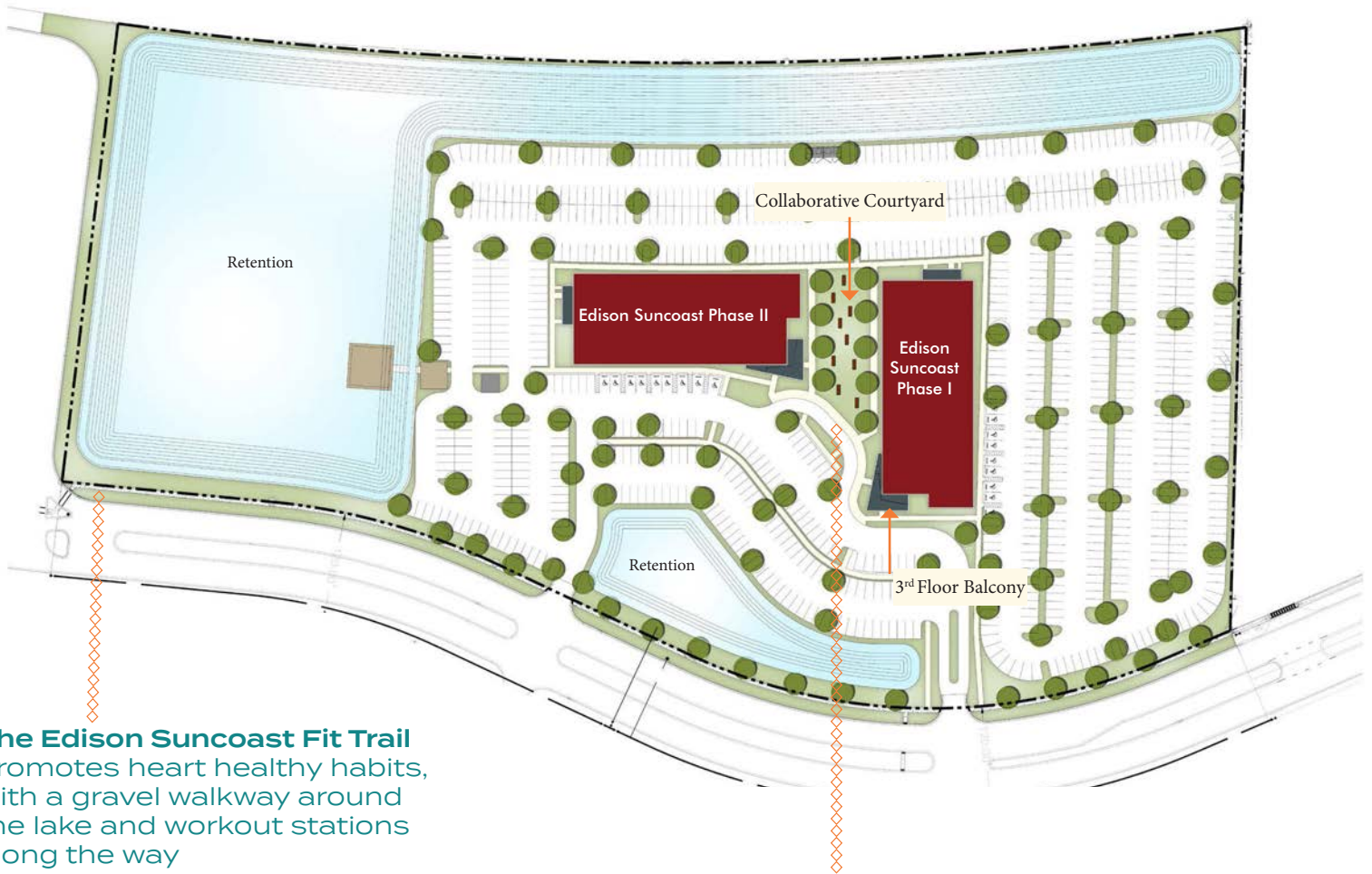

The Edison Suncoast Fit Trail promotes heart healthy habits, with a gravel walkway around the lake and workout stations along the way



Permanent **Food Truck** driveway in courtyard



SITE AREA: +/- 18.45 ACRES

NEW CONSTRUCTION
EXISTING OFFICE BUILDING
EDISON SUNCOAST PHASE I
1785 NORTHPOINTE PARKWAY
76,862 RSF
3 floors
Typical floor plan: 26,000 RSF
Parking ratio: 5.8/1,000 RSF

FUTURE DEVELOPMENT
EDISON SUNCOAST PHASE II
1675 NORTHPOINTE PARKWAY
76,862 RSF
3 floors
Typical floor plan: 26,000 RSF
Parking ratio: 5.8/1,000 RSF



NEW CONSTRUCTION OFFICE BUILDING

THE EDISON SUNCOAST

1785 NORTHPOINTE PARKWAY • LUTZ, FL 33558

54 CORRIDOR, PASCO COUNTY

CONTACT US

JAMES GARVEY

Senior Vice President

+1 813 334 1602

james.garvey@cbre.com

LARA SIEDER

First Vice President

+1 727 871 2145

lara.sieder@cbre.com

CBRE

© 2020 CBRE, Inc. All rights reserved. This information has been obtained from sources believed reliable, but has not been verified for accuracy or completeness. You should conduct a careful, independent investigation of the property and verify all information. Any reliance on this information is solely at your own risk. CBRE and the CBRE logo are service marks of CBRE, Inc. All other marks displayed on this document are the property of their respective owners, and the use of such logos does not imply any affiliation with or endorsement of CBRE. Photos herein are the property of their respective owners. Use of these images without the express written consent of the owner is prohibited.